

**HARDKORR**  
CAMPERS

GREAT FOR  
FAMILIES



# OUTBACK X PLOERER



**HKC15-HB**

**15FT. OFF-ROAD  
HYBRID CARAVAN  
WITH QUEEN BED + BUNKS**

*LIFE WITHOUT LIMITS*

# OUTBACK XPLORER

# HKC15-HB

## FEATURES:

<b>INTERNAL KITCHEN:</b>	Stainless steel sink, 2-burner Dometic® stove, 12v water pump, hot and cold water connections, dining table
<b>EXTERNAL KITCHEN:</b>	Gas 4-burner cooktop, slide-out stainless steel bench and sink, drying rack, LED light, hot and cold water connections
<b>BATHING:</b>	Internal ensuite with Thetford integrated shower/toilet vanity
<b>SLEEPING:</b>	Queen sized bed, two single bed bunks
<b>COMFORT:</b>	Sofa, reverse cycle air conditioning system, 2 x fans, Truma hot water system, LED TV and antenna, stereo with quad 4" speakers, tinted windows with insect screens & blackout blinds, optional diesel heater
<b>LIGHTING:</b>	LED lighting throughout
<b>STORAGE:</b>	Space for 2 x 9kg gas, external pantry, 96L fridge slide, 2 x 100L water, 80L grey water, Weber BBQ storage, generator storage, canvas/pole storage
<b>12V POWER:</b>	3000W AC switching pure sine wave inverter, 2 x 240AH LiFePO4 batteries, Hardkorr Bluetooth enabled battery monitor, 510W roof-mounted solar, 40A DC-DC with solar regulator, deluxe control panel with water and battery monitors, 7 x 12V points, 2 x dual USB points, 2 x 240V points
<b>AWNING:</b>	4000mm x 2000mm electric awning
<b>TRIM:</b>	Black alloy checker plate on front, sides, rear and wheel flares
<b>SAFETY:</b>	Rear recovery points, scrub bars, Australian standards compliant safety chains
<b>WHEELS &amp; TYRES:</b>	Premium alloy wheels with MT tyres including two full-size spares
<b>SET-UP TIME:</b>	5-10 minutes

## CONSTRUCTION:

<b>CHASSIS:</b>	Hot-dip galvanised steel 150mm x 50mm
<b>BODY:</b>	Composite aluminium panels, dual compression door locks, automotive rubber weather seals, 4 x stabiliser legs
<b>CARAVAN HITCH:</b>	Premium AL-KO 360° 50mm hitch
<b>SUSPENSION:</b>	Heavy-duty independent suspension, dual big-bore gas shocks
<b>HUB BEARINGS:</b>	Heavy-duty parallel
<b>BRAKES:</b>	12 inch electric drum brakes with hand brake
<b>JOCKEY:</b>	ARK XO 750

## SPECIFICATIONS:

<b>TOTAL LENGTH:</b>	6,500mm
<b>TOTAL WIDTH:</b>	2,200mm
<b>TRAVEL HEIGHT:</b>	2,700mm
<b>TARE WEIGHT (DRY):</b>	2,630kg
<b>ATM WEIGHT:</b>	3,000kg
<b>BALL WEIGHT:</b>	309kg
<b>WATER CAPACITY:</b>	200L (2 x 100L)
<b>WHEELS &amp; TYRES:</b>	265/75 R16 MT
<b>FRIDGE SLIDE:</b>	970mm x 550mm x 590mm

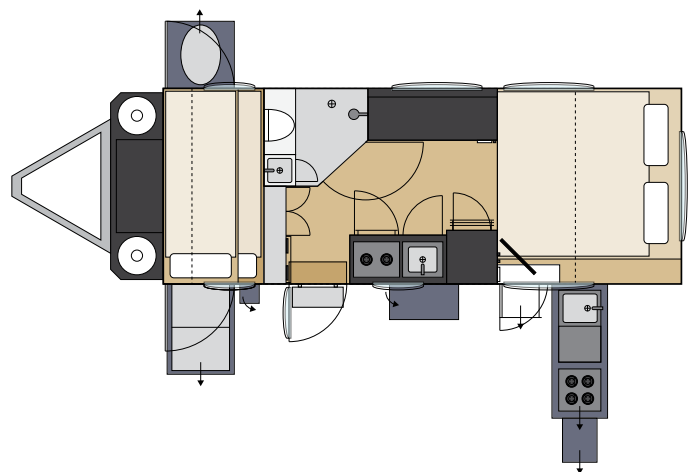

Bonus Inclusions + Optional Extras are not included in the Tare or Ball Weights. Some photos include optional extras. Option packs may change, please confirm on order.

All measurements are approximate and are dependent on each individual product.

Weights are estimated and subject to variation. Options and manufacturing changes will vary these weights.

This information should be used as a guide only. Please confirm with a Hardkorr Campers staff member prior to purchasing.